

PORTFOLIO



BENABI ACADEMY

FOCUS, PERSEVERE, AND DISCOVER



Content

- Recent Projects
- Impact of recent Projects
- Donors
- Future Projects
- Remarks



Recent Projects

- Funds and Playground
- Basketball and Table Tennis
- Footballs and Jerseys
- School Compound
- Science Laboratory



School Compound

Howard University, located in Washington, D.C., United States of America, tiled our school compound in July 2023.

Before



After



Playground

Our playground was refurbished in January 2024 by Elon University in North Carolina, United States of America.

Elon University also provided our basketball jerseys, footballs, table tennis, and trampoline.



Science Laboratory

Howard University
refurbished the science
laboratory in July 2024.



Financial support and painting

In May 2023, the University of Iowa offered financial assistance and contributed to painting the school block.



Impact of Recent projects



This section analyzes the impact of six key facilities at Benabi Academy on pupils' overall development across physical, social, academic, skill-based, and recreational areas.

Playground (20%) : Enhances pupils' physical health, teamwork, and emotional well-being through active play.

Footballs (20%) : Promotes physical fitness, coordination, and social skills via team sports.

Science Lab (20%) : Strengthens academic performance by enabling hands-on, inquiry-based scientific learning.

Basketball Jerseys (15%) : Fosters school spirit, participation, and unity during sporting events.

Table Tennis (15%) : Develops focus, quick reflexes, and sportsmanship in a recreational setting.

School Compound (10%) : Provides a clean, safe environment that supports learning and discipline.

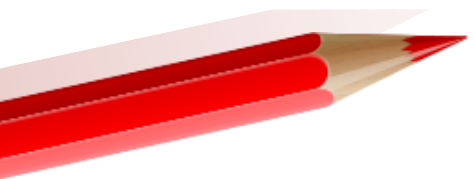
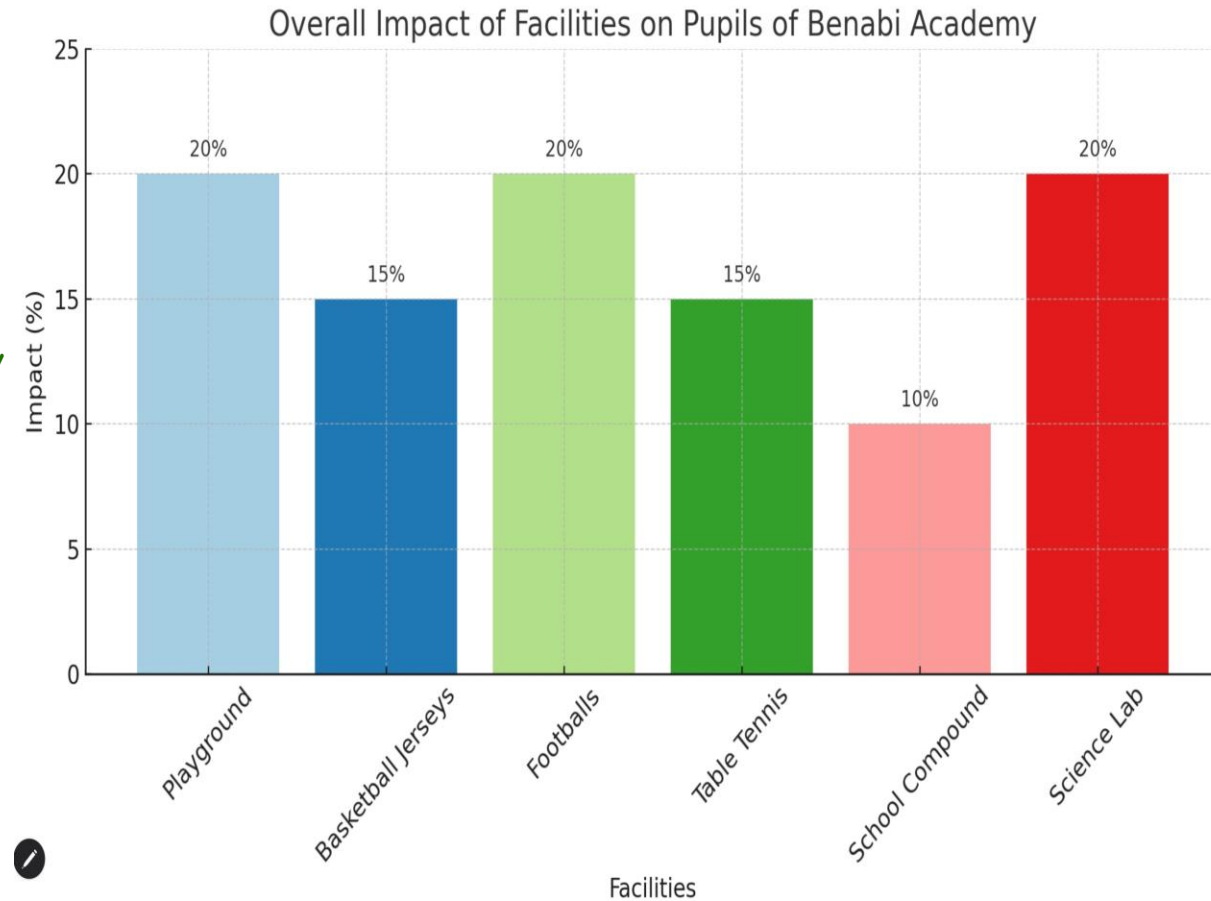

The analysis demonstrates that both academic and co-curricular facilities play vital roles in shaping well-rounded pupils. Investing in and maintaining these facilities not only supports immediate learning outcomes but also promotes long-term personal and social development.

Donors

- Iowa State University
- Elon University
- Howard University



Future Projects

- **Construction of a New School Block:**
The proposed structure will comprise a security post, assembly hall, dining hall and kitchen, computer laboratory, the head teacher's office, classrooms, and staff common room.
- **Library Furnishing:**
The library will be equipped with shelves, tables, chairs, and a variety of educational books to support student learning.
- **Computer Laboratory Setup:**
The computer lab will be furnished with 30 computers and appropriate furniture to facilitate digital literacy and computer-based learning.
- **Provision of additional Science Laboratory Equipment:**
The science laboratory will be equipped with the necessary tools and materials to enhance practical science education.
- **Support for Needy Children (Ages 6 to 14):**
Assistance will be provided to underprivileged children in the form of tuition fees, meals, transportation, books, and stationery to ensure equal access to education.
- **Borehole Water Treatment:**
Our existing borehole will be treated to provide better and purified water for the pupils of Benabi Academy.

Construction of a New School Building

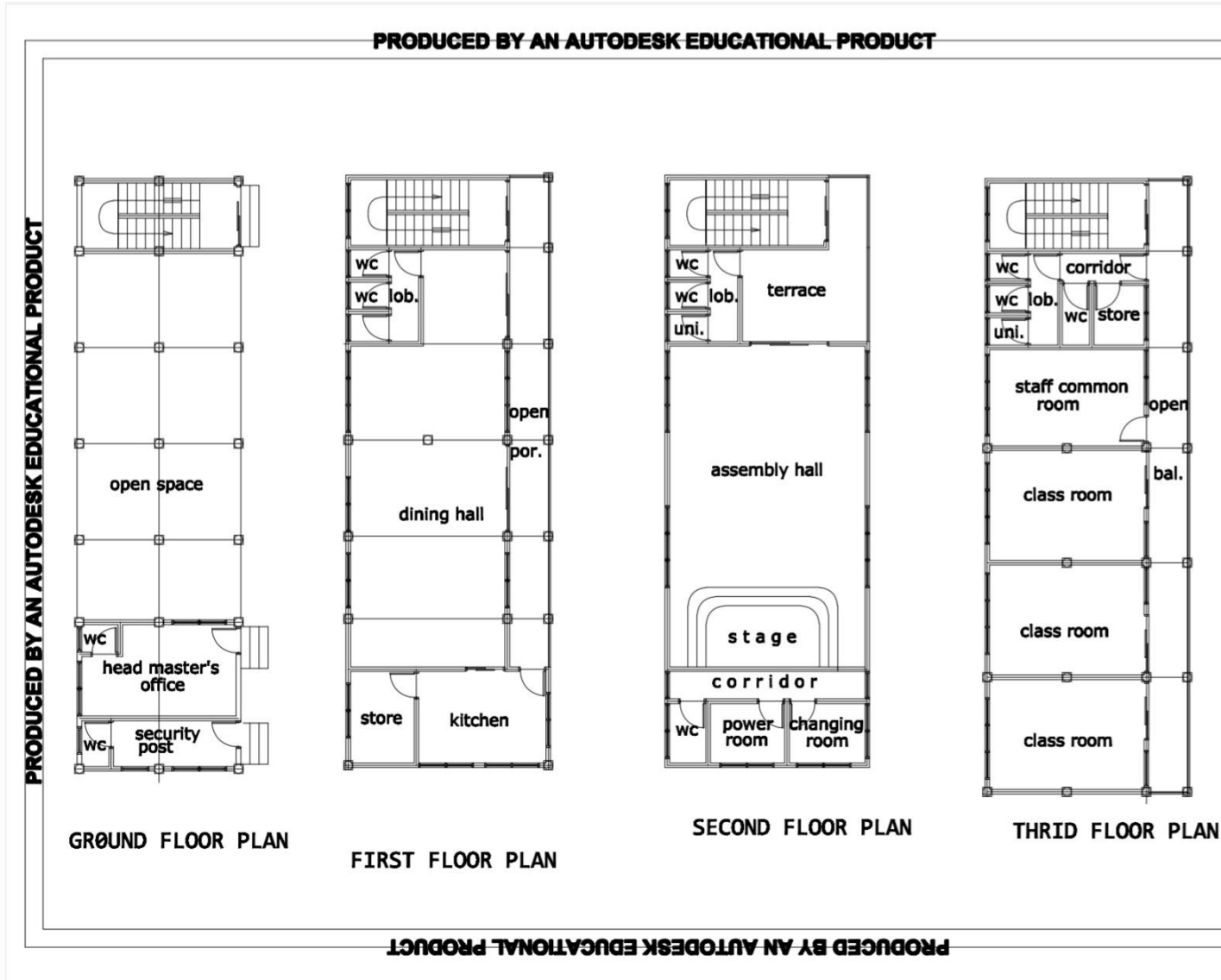

Estimate

- One floor costs: \$ 50,000
- A total of 4 floors costs: \$ 200,000

Library Furnishing



Estimate

\$ 15,000

Computer Laboratory Setup



Estimate
20 Computers: \$ 18,000

Provision of additional Science Laboratory Equipment



Estimate
\$ 5,000



Support for Needy Children (Ages 6 to 14)

Yearly Bills per Student :

Tuition: \$ 450 (4500 GHS)

Books and Stationery: \$ 200 (2000 GHS)

Feeding: \$ 400 (4000 GHS)

Total: \$ 1,050 (10,500 GHS)

10 Pupils will amount to \$ 10,500 (105,000 GHS)

Borehole Water Treatment

Estimate

\$ 5,000



**Your Support is truly valued.
Thank you**